

Impact sound insulation - outdoor

**REGUPOL sound and drain 22**

tiles with aluminium substructure on pedestals

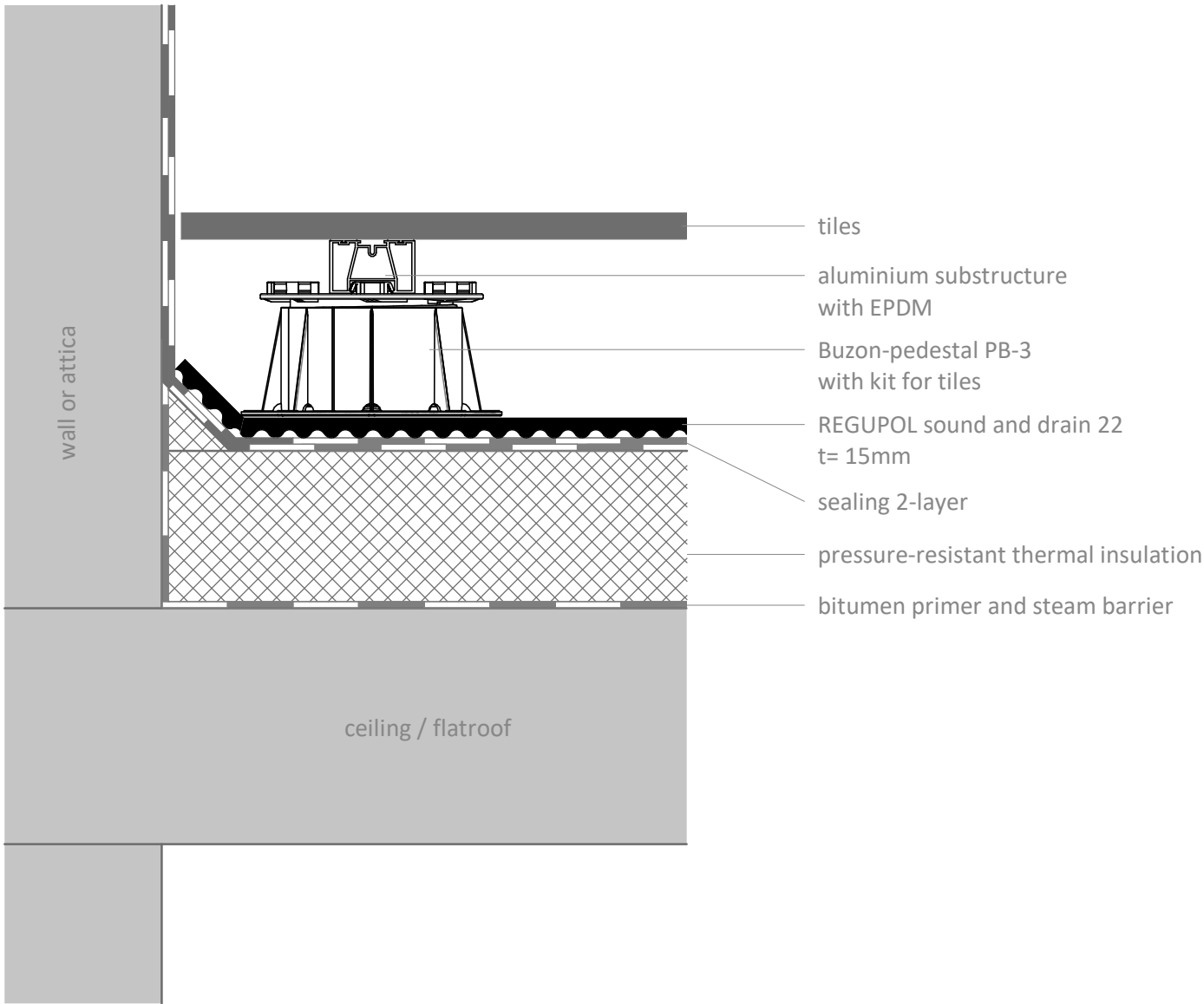

**Contact**

**REGUPOL BSW GmbH**  
 Am Hilgenacker 24  
 57319 Bad Berleburg  
 GERMANY  
 www.regupol.com

**Notes**

Adjacent trades are only shown schematically and in parts. The applicability and other conditions or constraints need to be checked by the customer or user on their own responsibility. The technical data sheets, installation instructions and local conditions need to be considered.

**Project:**

Project-No.:	---
Detail:	VSCHW-01-08-B-EN
Created by:	REGUPOL Acoustics
Date:	04.02.2022
Scale:	1 : 5