

Impact sound insulation - outdoor
REGUPOL sound and drain 22
 tiles with aluminium substructure on pedestals

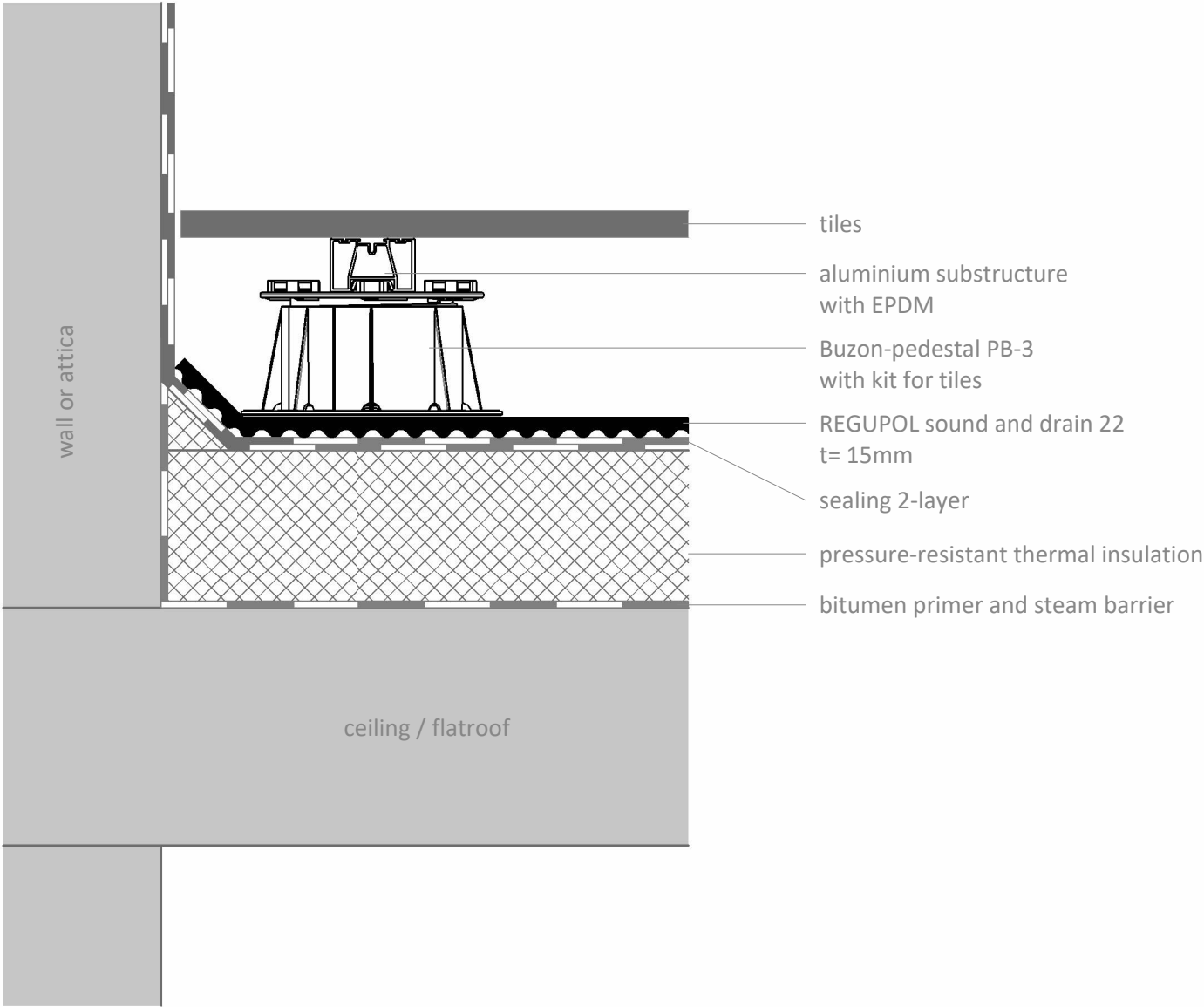

Contact

REGUPOL Germany GmbH & Co. KG
 Am Hilgenacker 24
 57319 Bad Berleburg
 GERMANY
 www.regupol.com

Notes

Adjacent trades are only shown schematically and in parts. The applicability and other conditions or constraints need to be checked by the customer or user on their own responsibility. The technical data sheets, installation instructions and local conditions need to be considered.

Project:

Project-No.:	---
Detail:	VSCHW-01-08-B-EN
Created by:	REGUPOL Acoustics
Date:	30.11.2023
Scale:	1 : 5