

Assembly

5/8" gypsum wall board
 7/8" x 25 ga furring channel
REGUPOL sonusclip @ 24" x 48" o.c.
 3-5/8" steel studs @ 24" o.c.
 6" nominal GFB insulation
 5/8" gypsum wall board

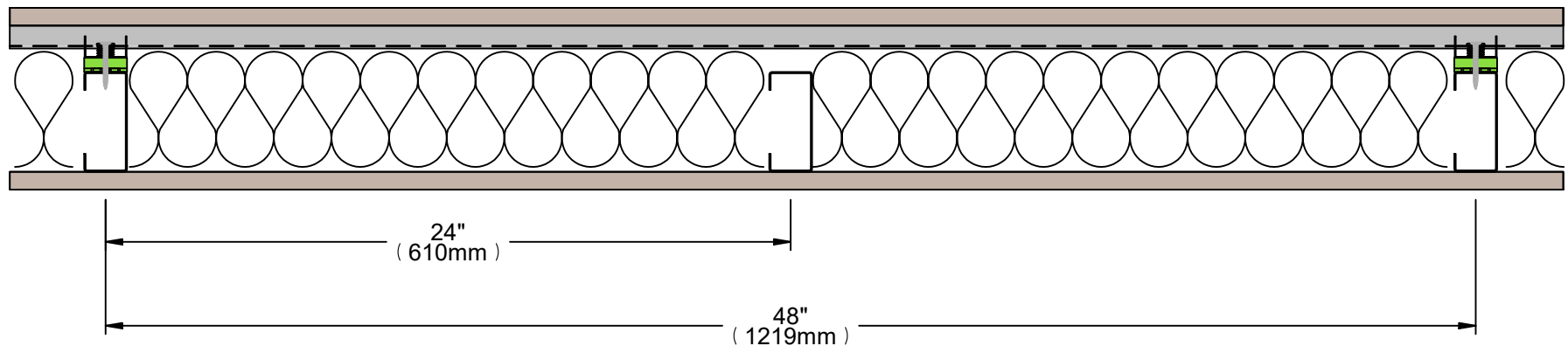

Contact

REGUPOL America LLC
 11 Ritter Way
 Lebanon, Pennsylvania 17042
 UNITED STATES OF AMERICA
www.regupol.com

Notes

Adjacent trades are only shown schematically and in parts. The applicability and other conditions or constraints need to be checked by the customer or user on their own responsibility. The technical data sheets, installation instructions and local conditions need to be considered.

Project:

Project no.:

Detail: sonusclip wall, channel 24" o.c.

Drawn by: DLG

Date: 4.13.2021

Scale: N/A

DWG no.: 1