

THE ANSWER TO HIGH-DENSITY LIVING IN MIXED-USE BUILDINGS

Quality of life thanks
to REGUPOL impact
sound insulation and
vibration isolation

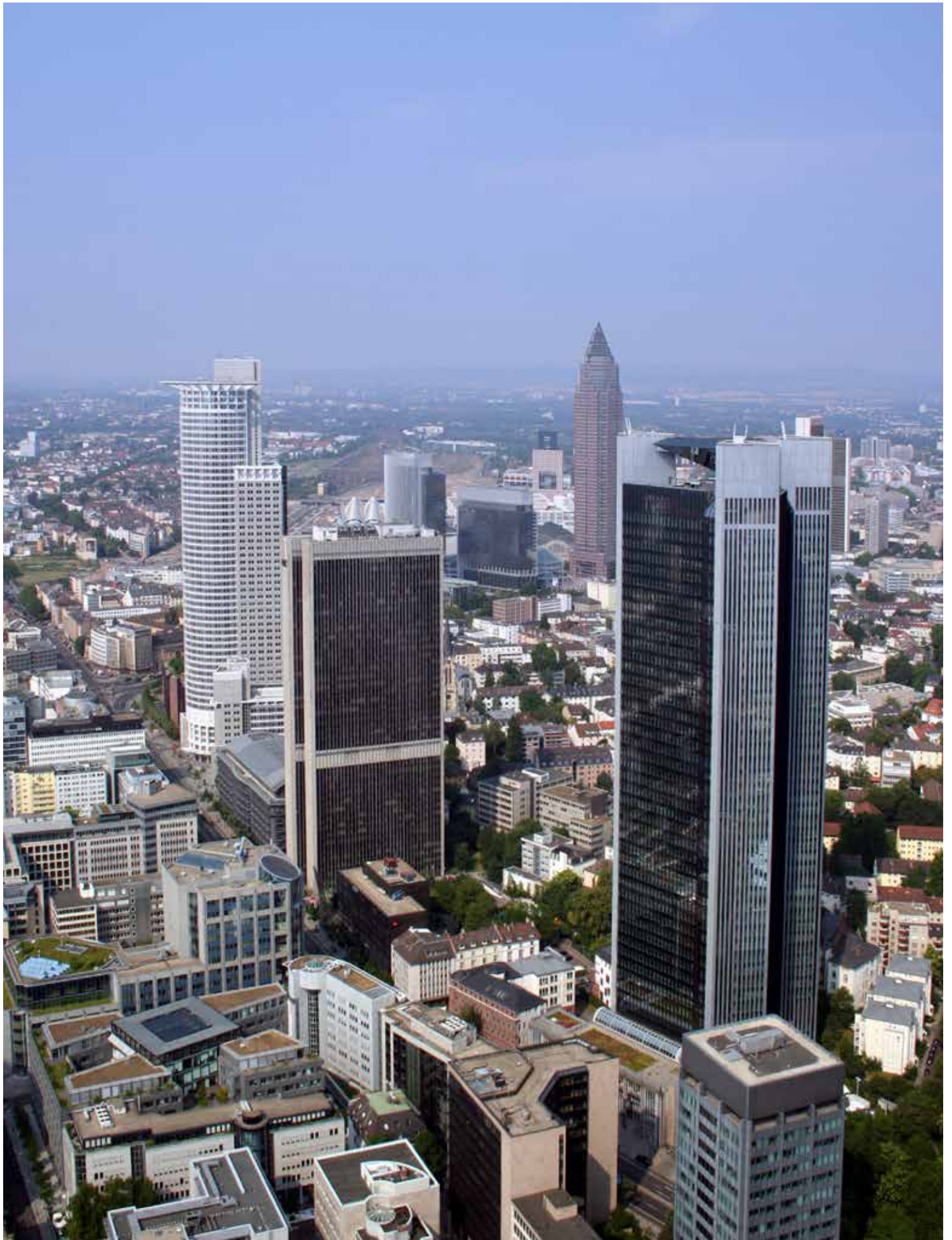

HOW DO YOU IMPROVE THE QUALITY OF **URBAN DEVELOPMENTS?** TOGETHER.

The world population is moving to cities. According to the United Nations' forecasts, seven out of ten people will live in urban cities by 2050. As a result, the once-popular methods of mixed-use development are becoming increasingly popular yet again. This trend is reshaping the fabric of urban areas and bringing many neighborhoods back to life.

Mixed-used buildings blend commercial, retail, and residential spaces with modern design, aesthetics, and taste. The focus is no longer on distinction between life, work, and play, but instead on the seamless integration of a whole lifestyle.

Imagine waking up in your apartment on the 21st floor of a 35-floor high-rise and getting ready for the day. Your upstairs neighbor is an indoor-cyclist devotee while the elderly couple below can sleep until noon. The building's floors are a blend of residential, commercial, and office spaces. You exit the lobby elevator and run into a friend headed to work on the seventh floor. You agree to meet for drinks after work at the rooftop bar. Before walking to work, you stop in the grocery store on the ground floor to buy some fruit for your lunch. Work, recreation, shopping—all within convenient reach.

Unfortunately, this trend poses significant acoustical issues. But with the right sound insulation, meeting the various needs in a single building can be easily achieved. As your experienced partner, we will assess your individual properties and provide high-quality design solutions to control noise and vibration, while ensuring you meet standards and regulations.

KEY TOPICS AT A GLANCE



06

The REGUPOL product range

Your key to effective noise control

10

Applications

Our products are suitable for a wide range of applications

24

Quality, Service, Sustainability

Our quality, services, and efforts to achieve sustainability

28

REGUPOL Group

Get a better insight into our company and international sales team

HOW DO YOU INSTALL EFFECTIVE SOUND INSULATION? TOGETHER.



POOL

REGUPOL or REGUFOAM vibration for the efficient structure-borne sound decoupling

ROOF TERRACES

REGUPOL sound and drain for impact sound insulation

SUPERMARKETS

REGUPOL or REGUFOAM sound for impact sound insulation

Contact us

Technical documentation for all **REGUPOL** acoustic solutions can be found at www.regupol.com/us/acoustics.

acoustics@regupol.com +1 800 537 8737

RESIDENTIAL
REGUPOL comfort and **REGUPOL sonus**
for impact sound insulation
REGUPOL sonusclips and **REGUFOAM hangers**
for false walls and suspended ceilings



FITNESS STUDIOS
REGUPOL sonusfit for structure-borne
sound and vibration protection

HOTELS
REGUPOL comfort and **REGUPOL sonus** for
impact sound insulation
REGUPOL sonusclips and **REGUFOAM hangers**
for false walls and suspended ceilings



REGUPOL comfort:
Elastomer-based impact sound insulation for various types of floor design and screeds



REGUPOL sonus:
Cork/PU or rubber-based impact sound insulation for screeds and floor coverings

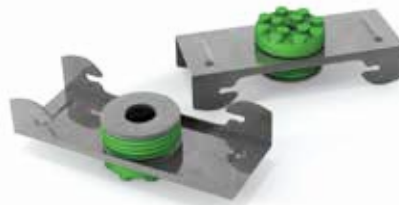

REGUPOL sonusclips:
Resilient sound isolation clips for mounting drywall



REGUFOAM hangers:
Highly efficient mountings for suspended ceilings



REGUPOL sound and drain:
Elastomer-based impact sound insulation for various types of terrace, bay window, and balcony designs

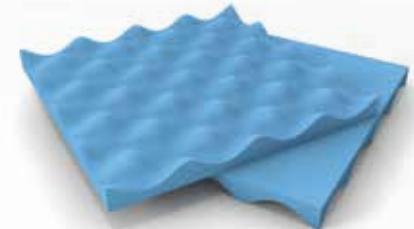

REGUPOL or REGUFOAM sound:
Elastomer-based impact sound insulation for various types of floor design and screeds that need to meet the highest acoustic requirements



REGUPOL sonusfit:
Highly efficient fitness studio soundproofing solutions incorporating sports-specific functional characteristics



REGUPOL or REGUFOAM vibration:
Effective solutions for vibration isolation and structure-borne sound decoupling

The presence of unwanted noise or vibration can be debilitating. At REGUPOL, we work side-by-side with acousticians, architects, and developers to create spaces free of unwanted sounds and vibrations. They rely on our product versatility, flexibility, and know-how to enhance the acoustic value of their projects.

Restaurants below condominiums units. Fitness centers within an apartment building. Grocery stores on the first level of a residential building. Rooftop bars and pools. We see all sorts of combinations and noise sources. **REGUPOL** will support you to make the unseen changes that can transform your daily experience in diverse environments.

Over the years, **REGUPOL** has evolved into a worldwide leader of acoustical solutions. We specialize in manufacturing acoustical, vibration, and noise abatement solutions that deliver quality and performance. Join our growing list of satisfied customers. Trust **REGUPOL**.

Your benefits:

- reliable planning support and product performance
- a broad range of products and system solutions enable versatile design solutions
- decades of experience

HOW DO YOU BUILD A
**HOME IN THE MIDDLE
OF A CITY?**
TOGETHER.

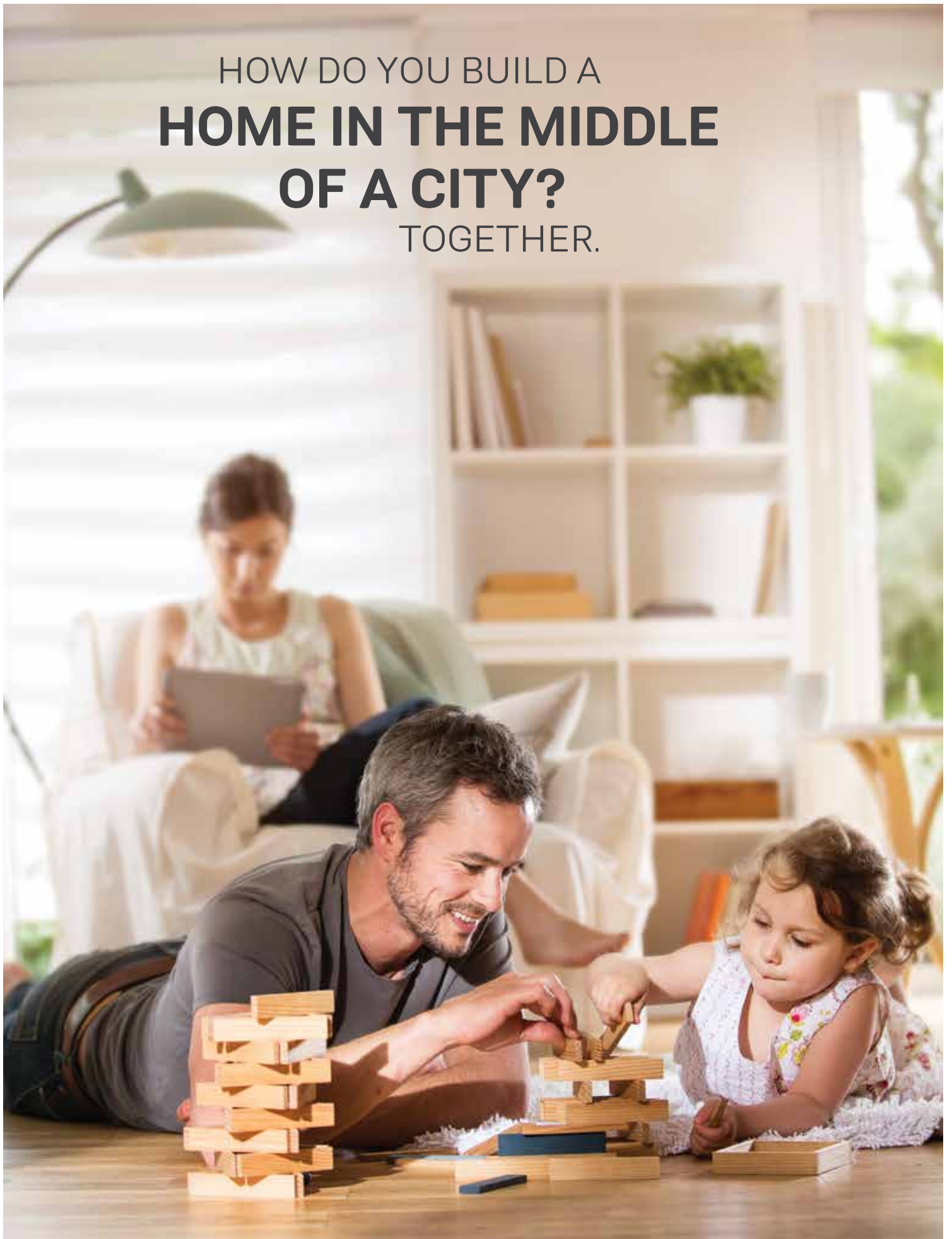

Increasingly, people are living in cities permanently. Growing urbanization inevitably leads to new challenges for noise mitigation that require intelligent solutions.

Quality of life in residential and mixed-use buildings can be improved through good acoustics. Depending on your specific situation, construction methods, and project stage, we can help recommend the right concept and **REGUPOL** products for your needs. The more flexible and versatile these solutions are, the more sustainable the result. With our experts at your side, designing a wide variety of solutions and testing them for cost-effectiveness is easily achieved.

The **REGUPOL sonus** range includes both smooth and profiled versions that make designing specific underfloor solutions, including bonding technology, as well as a wide range of under-screed impact sound insulations, easy. **REGUPOL** products are tested to ISO and ASTM standards and can also be tailored to the needs of your specific projects.

The **REGUPOL comfort** range is especially attractive to customers in Europe. Thanks to CE certification, it can be installed with confidence throughout the European Economic Area. Every product is tested according to ISO standards and features minimal thickness combined with high impact sound reduction.

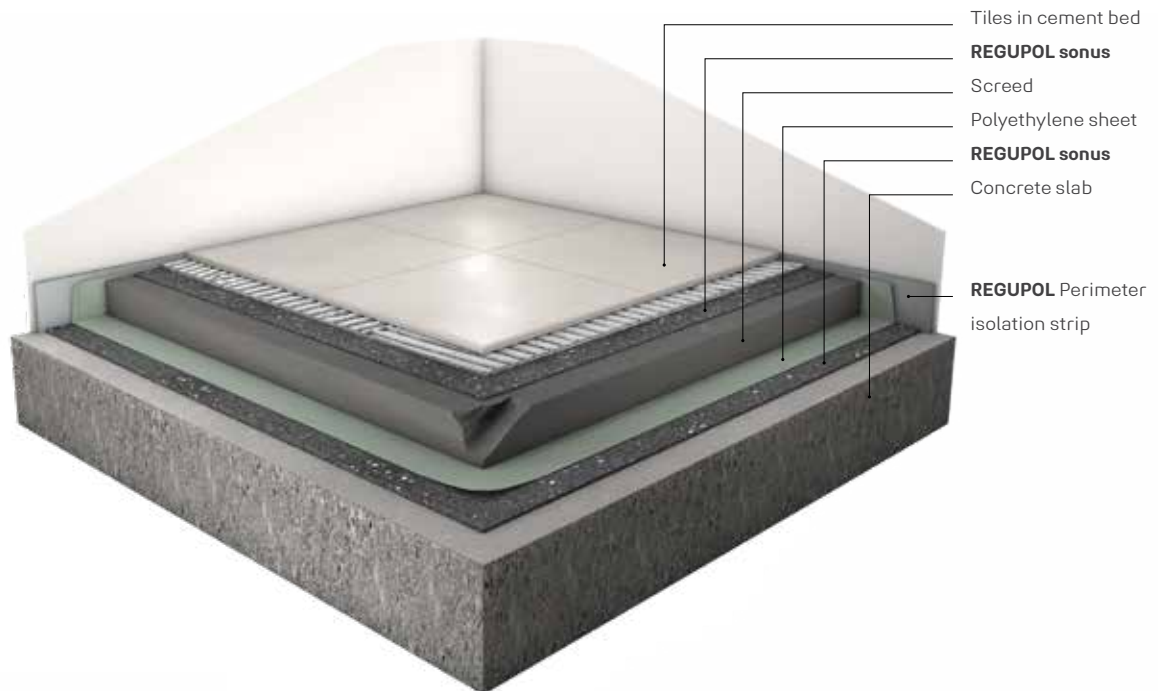

REGUPOL comfort



REGUPOL sonus



Our tip:

Ask us about the system components – such as adhesives and primers – suitable for each individual **REGUPOL** product. Our experts are glad to support you.



When it comes to effectively reducing airborne noise between rooms, decoupled elastic false walls provide an excellent globally proven solution. With **REGUPOL**, legal and contractual acoustic requirements can be met relatively easily.

REGUPOL sonusclips stop structure-borne noise bridging the dry wall and the false wall. Easy-to-install, these rubber and metal fasteners can achieve excellent acoustic building values even where little wall mass is available – something that offers acoustic technicians and architects alike a clear advantage when it comes to structural flexibility.

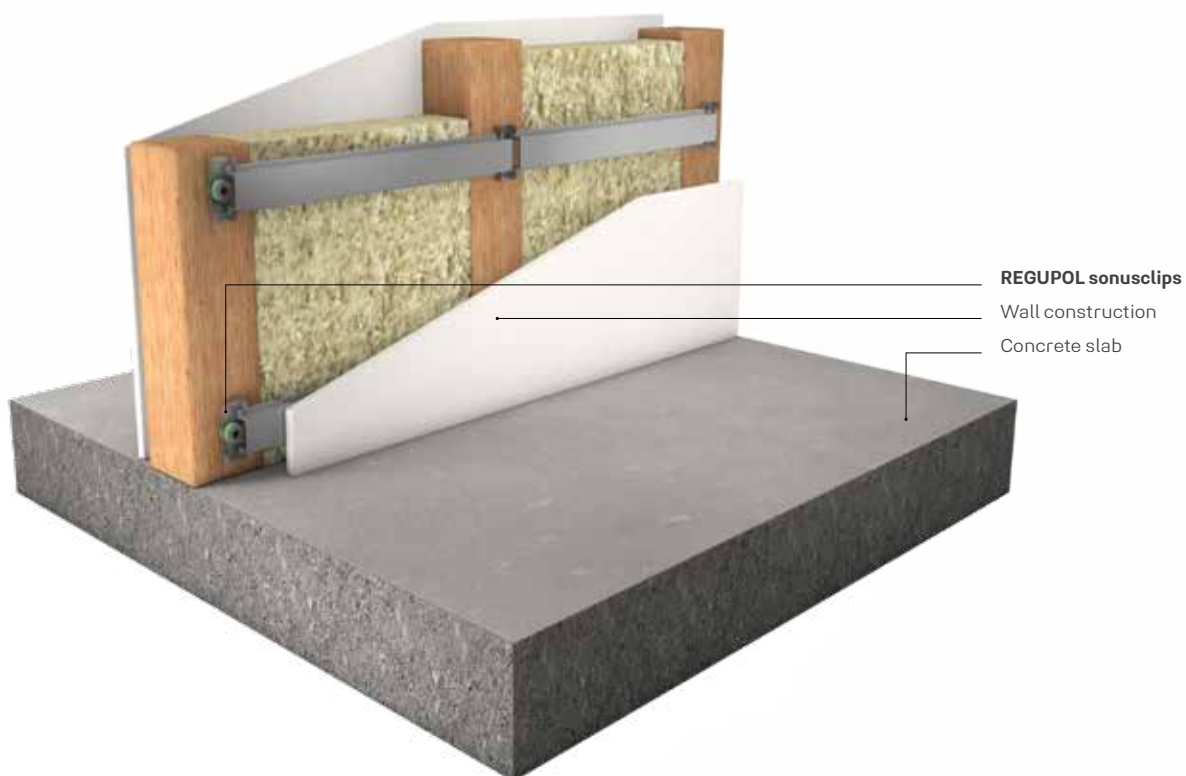

REGUPOL sonusclips



HOW DO WE CREATE A
CITY OF SHORT DISTANCES?
TOGETHER.



In highly populated neighborhoods and mixed-use buildings, convenient access to goods and services is a major issue. This comes as the result of demographic change and the reduced mobility it entails.

Easy access to stores improves the quality of residents' lives considerably. However, it also requires improving the acoustic performance of buildings so that residential and commercial buildings can coexist peacefully. Especially where the delivery and loading of goods outside opening hours is concerned.

To effectively reduce low-frequency structure-borne noise as well as noises being emitted by cars and trucks, the experts at **REGUPOL** have developed **REGUPOL** and **REGUFOAM sound**. These highly resilient screed insulation underlays can be used under heavy screeds and slabs.

Our portfolio of solutions ensures reliable building design in this sensitive application. What's more, **REGUPOL** and **REGUFOAM sound** are the right choices for a host of other applications including, cinemas, theatres, libraries, workshops, and vehicle accessible areas in factories where particularly noisy activities need to be isolated from quiet spaces in residential and commercial buildings. Ask **REGUPOL** acoustics experts.

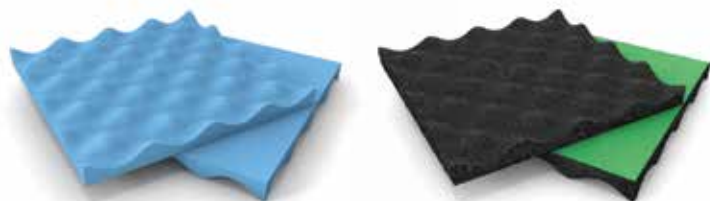
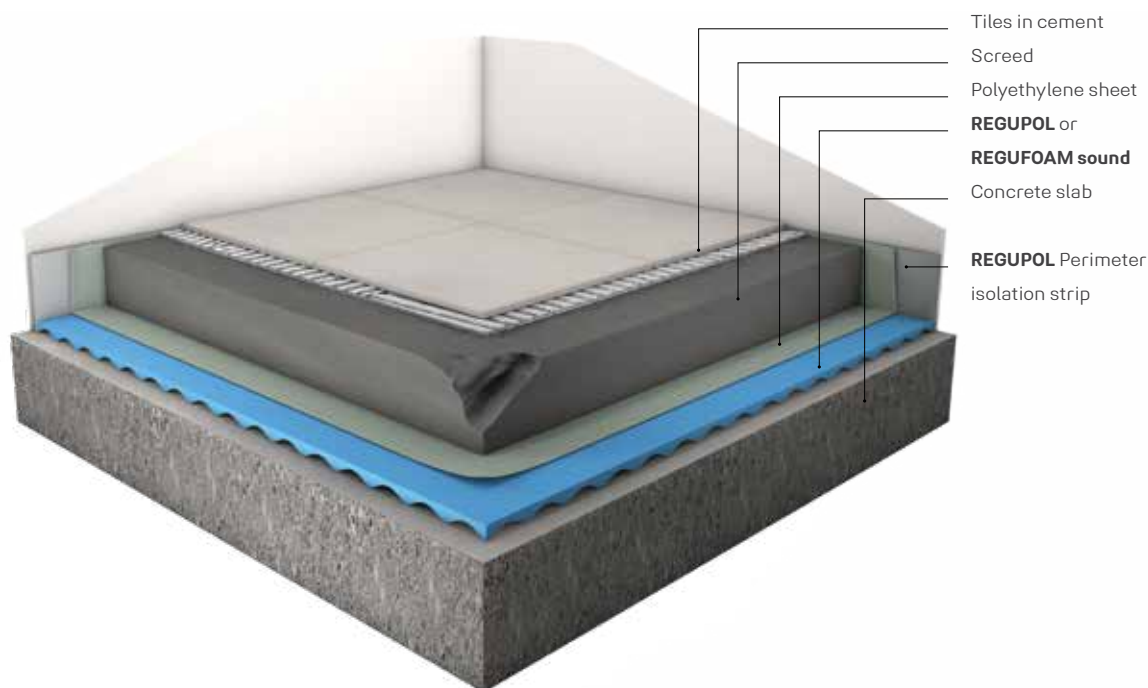

REGUPOL and **REGUFOAM sound** product ranges are tested according to ISO standards and offer maximum sound reduction at low thicknesses.

Our tip:

All **REGUPOL** and **REGUFOAM sound** impact insulation membranes are tested in Germany and certified throughout the EU – their quality is recognized worldwide.

HOW DO YOU ENSURE
RELAXED URBAN LIFESTYLES?
TOGETHER.

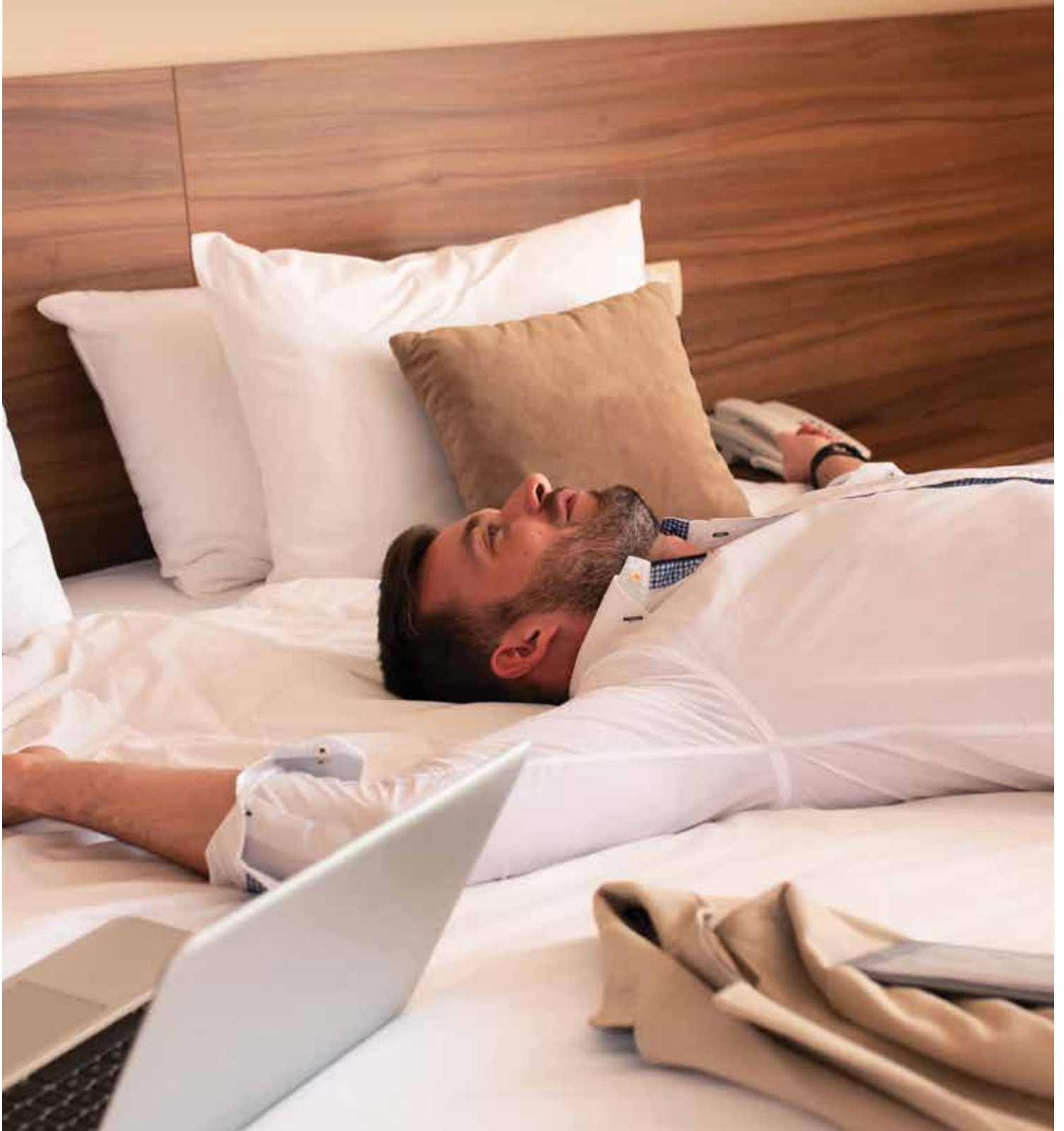

For city hotels, a central location and proximity to transportation is essential. Likewise, hotels need to guarantee their guests peace and quiet, especially in an attractive mixed-use environment where the hotel itself is a source of noise.

Strictly speaking, every hotel is a mixed-use concept in its own right. In addition to the rooms, which need to offer guests maximum peace and quiet, hotels combine elevators, stairwells and technical infrastructure, receptions, bars, meeting rooms, and dining in a very small space. When located in a tower or other mixed-use building, further noise factors come into the mix.

As a specialist designer, you are faced with the task of mastering the complex interplay of airborne, impact, and structure-borne noise from a wide variety of sources.

As a long standing partner, we offer you reliable planning support, high performance products, and a wide range of solutions that free up your design options.

With the **REGUPOL sonus** or **REGUPOL comfort** product ranges, we offer you a comprehensive portfolio of under screed and underfloor impact sound solutions. Plus, **REGUPOL sonusclips** and **REGUFOAM hangers** enable you to retrofit drywall or existing constructions with airborne and impact sound insulation.



REGUPOL sonus



REGUPOL comfort



REGUPOL sonusclips and REGUFOAM hangers



Good to know:

Technical documentation for all **REGUPOL** acoustic solutions can be found at
www.regupol.com/us/acoustics.
acoustics@regupol.com +1 800 537 8737

HOW DO YOU
**TURN A ROOF INTO
SOMETHING SPECIAL?**
TOGETHER.





Roof terraces are becoming increasingly popular places to meet. Cleverly used and soundproofed, they make attractive destinations for tenants or locations for restaurants as well as other modern concepts.

A star-lit sky lounge or an extra-large barbeque in a fashionable restaurant — hotel roof gardens and terraces are in vogue all over the world. **REGUPOL sound and drain** impact sound insulation provides peace and quiet in the living spaces and bedrooms below. Thanks to European CE label certification, it is fully compliant across the EU.

In addition to its acoustic properties, **REGUPOL sound and drain** also acts as a fully waterproof roof membrane complete with water drainage properties. Let us support you!

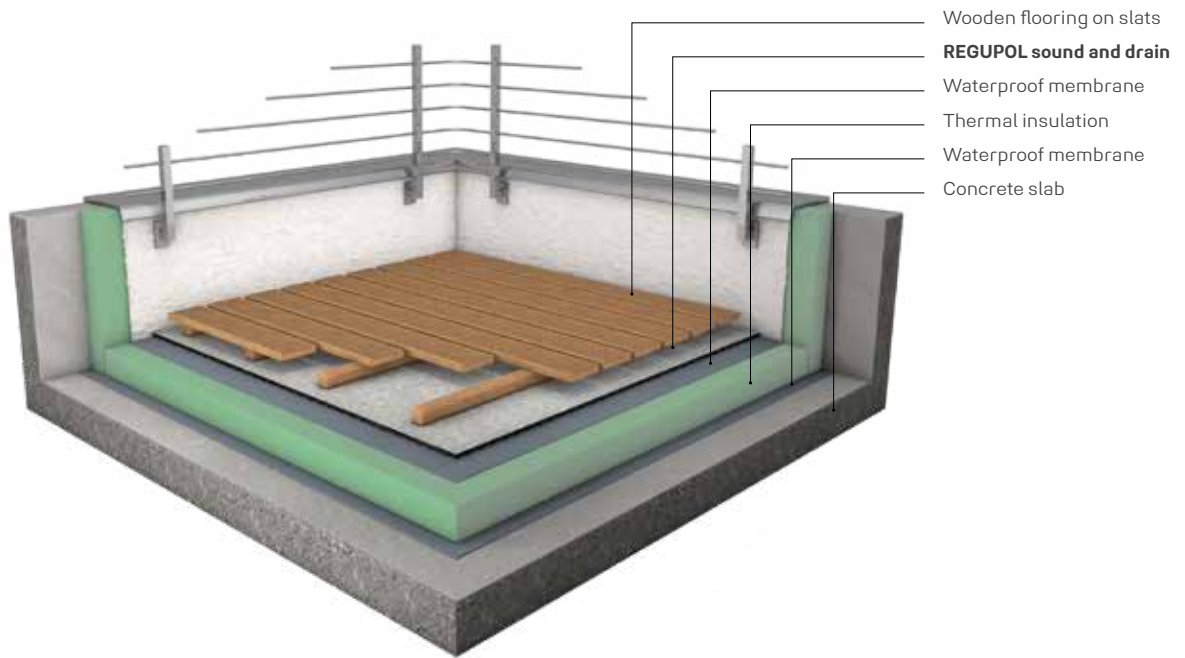

REGUPOL sound and drain



HOW DO YOU
MUFFLE THE
CLANG OF BARBELLS?
TOGETHER.

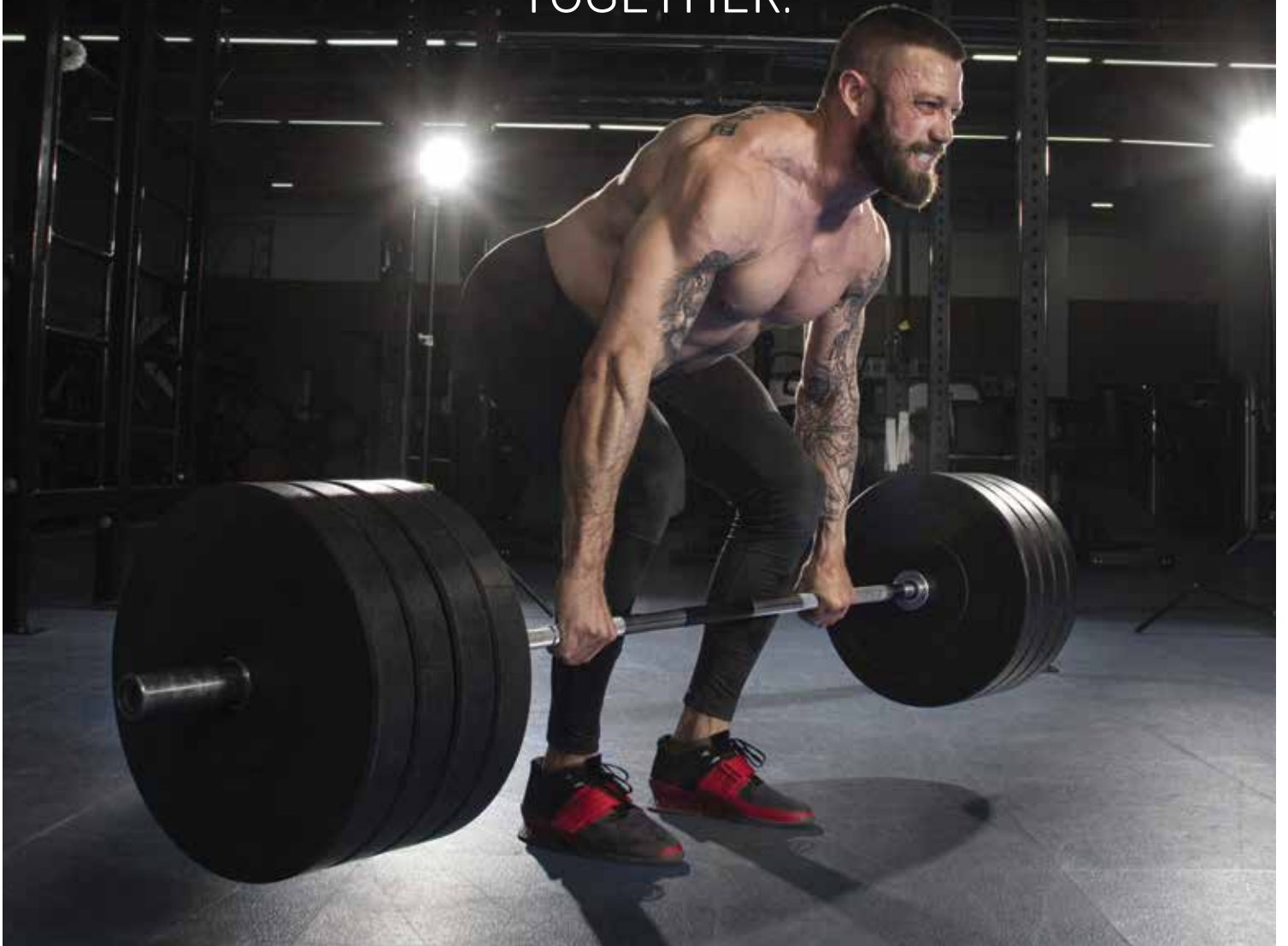

Fitness studios are more popular than ever. Gyms located in residential and commercial buildings translate into short distances and easy access, but they present complex acoustic challenges.

From the jarring noise of dropped weights and slam ball sessions to group exercise classes set to a thumping bass beat, today's most popular fitness environments create a lot of noise. Neighbors above, adjacent, and especially below, find the noise intolerable. Successful control of this type of noise requires careful planning and often specialty construction techniques. Each design is implemented without impairing the functional properties of the sports surface.

As an expert in acoustic protection and a leading supplier of sports and fitness surfaces, **REGUPOL** offers solutions meeting the requirements of both sectors. The **REGUPOL aktiv** and **REGUPOL sonusfit** product ranges offer functional sports properties combined with highly effective sound insulation - ask the experts!



REGUPOL aktiv



REGUPOL sonusfit



HOW DO YOU GUARANTEE
THE RIGHT POOL DESIGN?
TOGETHER.





Pools make a great addition to various types of mixed-use buildings, but they need to be properly insulated.

Pool noise is generated by swimmers pushing off from the edge of the pool or jumping into the water. Busy pools can be very noisy. But even a few leisurely laps can compromise sophisticated mixed-use concepts. Retrospectively, it is difficult to supplement or improve existing soundproofing solutions.

Part of our comprehensive range, which also includes approved and externally monitored specialist solutions, **REGUPOL** and **REGUFOAM vibration** products meet all the prerequisites of precision tailored solutions and reliable design in this sensitive area of application. Ask the experts for detailed advice on selecting the right product and elastic mounts.

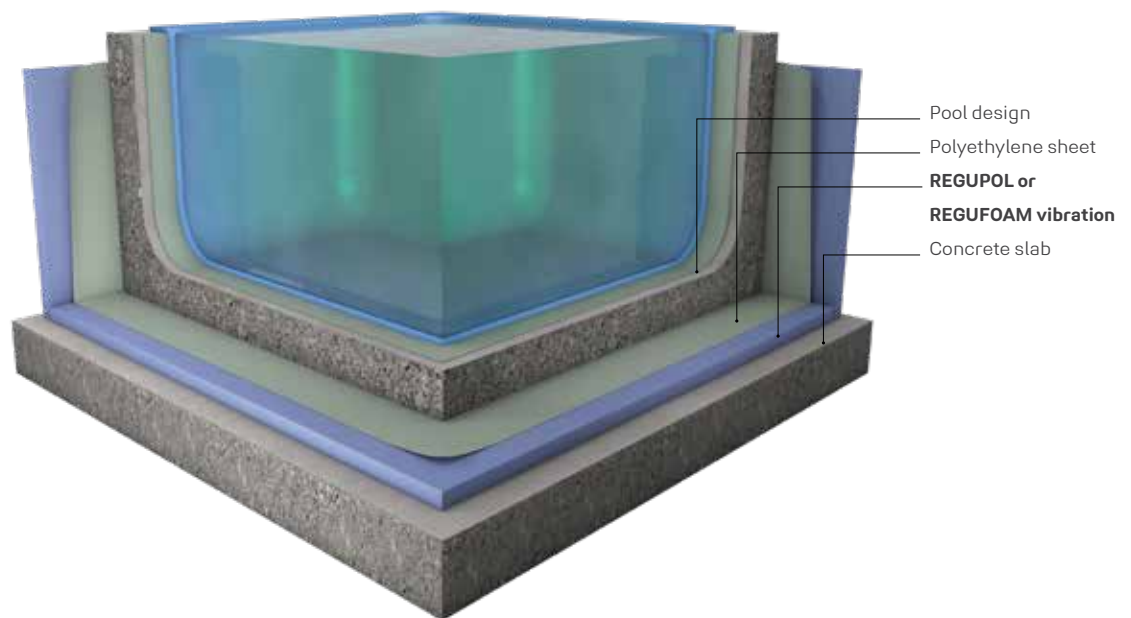

REGUFOAM vibration



REGUPOL vibration



Our tip:

More and more pools are being built on the rooftops of upscale mixed-use buildings. In these applications, combining **REGUPOL sound and drain** provides an ideal solution.



HOW ARE SOLUTIONS EASY AND INSPIRING? **TOGETHER**

We've got it covered.

REGUPOL is more than sports and multi-purpose surfaces. More than our acoustic underlayments. And more than our state-of-the-art track and field surfaces. For over 65 years, providing solutions and delivering exceptional customer service has been our business. We understand that paying attention to the details is critical from the start of any project. Making changes later means inconvenience and additional expenses. We sweat those details so you don't have to.

Because we invented the technology to recycle tires into unique products, you benefit from decades of experience and expertise that only we can offer. That means the right information, advice, and answers when you need them, along with products that have been refined, tested, and retested over the years by our R&D team to deliver precision performance that will not disappoint. It is all accomplished with manufacturing that meets the highest quality standards with the strictest environmental requirements.

Delivering results, developing leaders worldwide

We have grown steadily since 1954 – new products developed, new subsidiaries established and new locations added. Today, **REGUPOL** is still a family enterprise, with third and fourth generations currently working in company management. We have eleven offices in seven countries, all serving as epicenters for innovation, ingenuity, and community.

Behind every **REGUPOL** product, there is a talented team that works together, across the globe, to create performance solutions from reclaimed materials that deliver durability and protection where you need it most without sacrificing sustainability. Whether used to protect surfaces and optimize load transport or to dampen sound and vibration, **REGUPOL** gets it done. We deliver with a level of product, customer service, and investment that only the inventor can offer.

No matter the customer—we aim to make their experience easy and inspiring, at an only-at-**REGUPOL** value.

Customer service excellence for over 65 years.



Ask our experts about the optimal
Solution for your project:
sales@regupol.com | +1 800 537 8737

 **REGUPOL**

Raw material procurement

Recycling

Product design

Production

Distribution

Use

HOW TO ACT MORE SUSTAINABLE? TOGETHER

Caring about the environment is part of the REGUPOL core mission. When it comes to how we conduct our business and develop our products, we think long term. We ask ourselves: How will our actions today impact tomorrow's world? We strive to protect and sustain our environment every step of the way, from development and production to customer use and disposal.

On the road, tires eventually wear down or sustain irreparable damage. But, in the environment, tires can last forever. They are nonbiodegradable, unable to be compacted like plastic or metal, and maintain their shape. Because of their sheer size and impenetrable rubber compound, tires are among the most problematic sources of waste we face today.

Each year we reclaim over 9 million tires (or 90,000 tons of SBR) from landfills to make environmentally sound solutions for the sports, acoustics, commercial, construction, and transportation markets. Our products are comprised of either shredded and cleaned SBR tire rubber (100% post-consumer waste) or a combination of SBR tire rubber and vibrant EPDM (post-industrial waste) color granules. The recycled content ranges from 75% to 100% recycled materials.

We understand that sustainability is not only about material content, which is why our manufacturing facility is near our rubber supplier. By eliminating excessive fuel use created through transportation of resources, fossil fuel expenditures are minimized, and atmospheric damage reduced. We are practically a zero-waste manufacturer regrinding our scrap material for use in some of our products.

There is an increasing demand for honesty and transparency from manufacturers. We were the first Pennsylvania manufacturer to be GreenCircle Certified. They provide independent verification of our products annually to ensure the legitimacy of our recycled content claims. But our commitment to sustainability does not end there; we've gone one step further. We work with UL Environment to independently certify our Environmental Product Declaration (EPD) to better understand and communicate the sustainable qualities and the life-cycle impact of our products.

Products used in the built environment should meet specific criteria for the health and safety of all occupants. These are called Health Product Declarations (HPDs) and are the standardized way of reporting the contents of building products. It is a valuable tool for not only encouraging transparency, it creates a sense of brand trust and is safer for anyone using the property. We make HPDs readily available for our family of brands including Aktiv, Sonus, and Revolution.

We are active USGBC members and our products can potentially assist architects and designers in earning points under 2 out of 9 categories—Materials and Resources and Indoor Environmental Quality—of LEED certification v4.1.





700

Employees

11

Locations worldwide

90,000

Tons of high quality rubber per year

132

Countries served worldwide



HOW DO YOU GROW TO THE TOP? **TOGETHER**

When you partner with REGUPOL, you become part of a community with a shared goal of leading with excellence and innovation. Our path to success has always been rooted in product innovation and great service, with an eye on the future. We transform over 90,000 tons of high-quality rubber every year to create products that meet and exceed industry standards.

Over the course of our 65-year journey to become a leader in our category of building materials, we have built up a wealth of expertise and forged long-term customer partnerships in 132 countries worldwide—like sprint legend Usain Bolt, who made history on our blue **REGUPOL** running track in Berlin's Olympic Stadium in 2009 when he set two world records.

"There's nothing like running on REGUPOL. To me, REGUPOL equals gold. In more ways than one." – Usain Bolt

We've got it covered.



REGUPOL America LLC

11 Ritter Way
Lebanon, PA 17042
phone +1 800 537 8737
info@**REGUPOL**.com

REGUPOL BSW GmbH

REGUPOL Australia Pty. Ltd.

REGUPOL Acoustics Middle East FZE

REGUPOL Schweiz AG

REGUPOL Zebra Athletics LLC

BSW Shanghai CO. LTD.

REGUPOL.us

©2021 REGUPOL America LLC | 11 Ritter Way Lebanon, PA 17042
REGUPOL is a registered trademark of REGUPOL BSW GmbH